

NOTICE OF PUBLIC HEARING

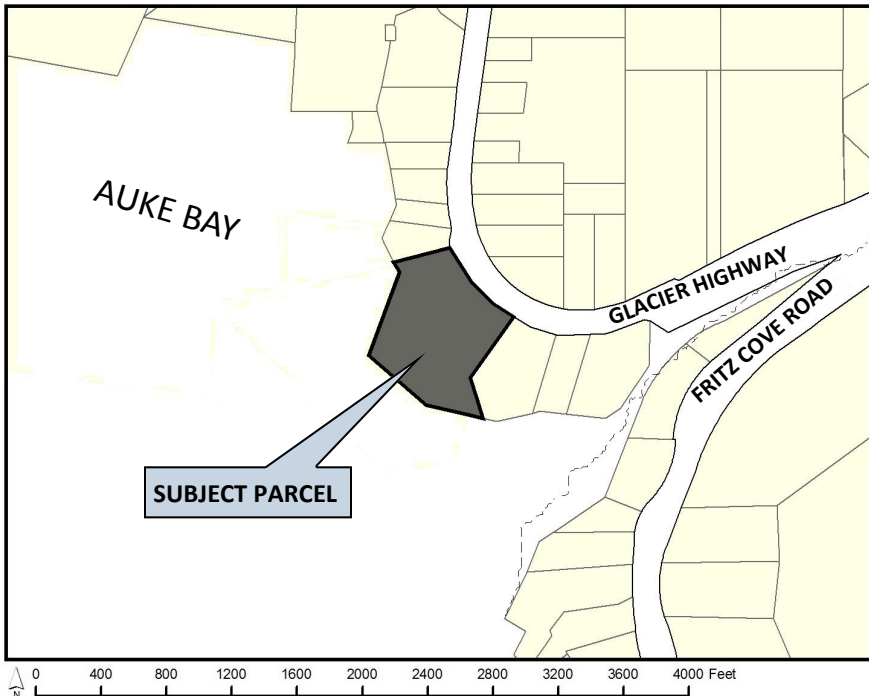

City & Borough of Juneau
 Community Development Department
 155 S Seward St • Juneau, Alaska 99801

SHIP TO:



PROPOSAL: CBJ acquisition of a portion of the Auke Bay Marine Station from the federal government.

File No:	CSP2017 0009	Applicant:	City & Borough of Juneau
To:	Neighborhood Associations	Property PCN:	4B2301050040
Hearing Date:	June 13, 2017	Owner:	NOAA
Hearing Time:	7:00 PM	Lot Size:	161,172 sq. ft.
Place:	Assembly Chambers Municipal Building 155 South Seward Street Juneau, Alaska 99801	Zoned:	WC (Waterfront Commercial)
		Site Address:	11305 Glacier Highway
		Accessed Via:	Glacier Highway

PROPERTY OWNERS PLEASE NOTE:

You are invited to attend this Public Hearing and present oral testimony. The Planning Commission will also consider written testimony. You are encouraged to submit written material to the Community Development Department 14 days prior to the Public Hearing. Materials received by this deadline are included in the information packet given to the Planning Commission a week before the Public Hearing. Written material received after the deadline will be provided to the Planning Commission at the Public Hearing.



If you have questions, please contact Chrissy Steadman at Christine.steadman@juneau.org or (907) 586-0761.

Planning Commission Agendas, Staff Reports and Meeting Results can be viewed at <http://www.juneau.org/assembly/novus.php>